

STOSTUCCO SHEETS

1. KEEP DRY BEFORE USING
2. READ SPECIFICATIONS and CHECK DRAWINGS, DETAILS, FRAMING, UNDERLAY, FLASHING TAPES, BLOCKING IS SATISFACTORY
3. INSTALL STO uPVC TRAY & JOINERY FLASHING AS PER STO DETAILS (builder to supply aluminium head flashing)
4. CHECK LAYOUT AND INSTALL SHEETS - STARTING FROM THE BOTTOM PLATE
5. STAGGER VERTICAL SHEET JOINS TO AVOID CONTINUOUS JOINS - EXCEPT AT CONTROL JOINTS
6. SECURE SHEETS WITH FIXINGS AS PER DETAILS
7. EXTERNAL and INTERNAL CORNERS TO BE CONTINUOUS 200mm MIN. AROUND CORNER or TO NEXT BATTEN
8. MEASURE DISTANCES ACCURATELY TO AVOID NARROW INFILL or GAPS

SAFE WORKING PRACTICE

1. HAVE SUFFICIENT EXPERIENCED TRADES PEOPLES
2. WEAR PROTECTIVE CLOTHING, EYE & EAR PROTECTION AND DUST MASK or RESPIRATOR WHEN SANDING or CUTTING
3. USE A CIRCULAR SAW FITTED WITH A METAL BLADE
4. PROVIDE SUITABLE ACCESS PLATFORMS, EQUIPMENT AND TOOLS TO CARRY OUT WORK
5. COMPLY WITH HEALTH AND SAFETY REGULATIONS AND MAINTAIN FIRST AID EQUIPMENT as per LEGISLATION

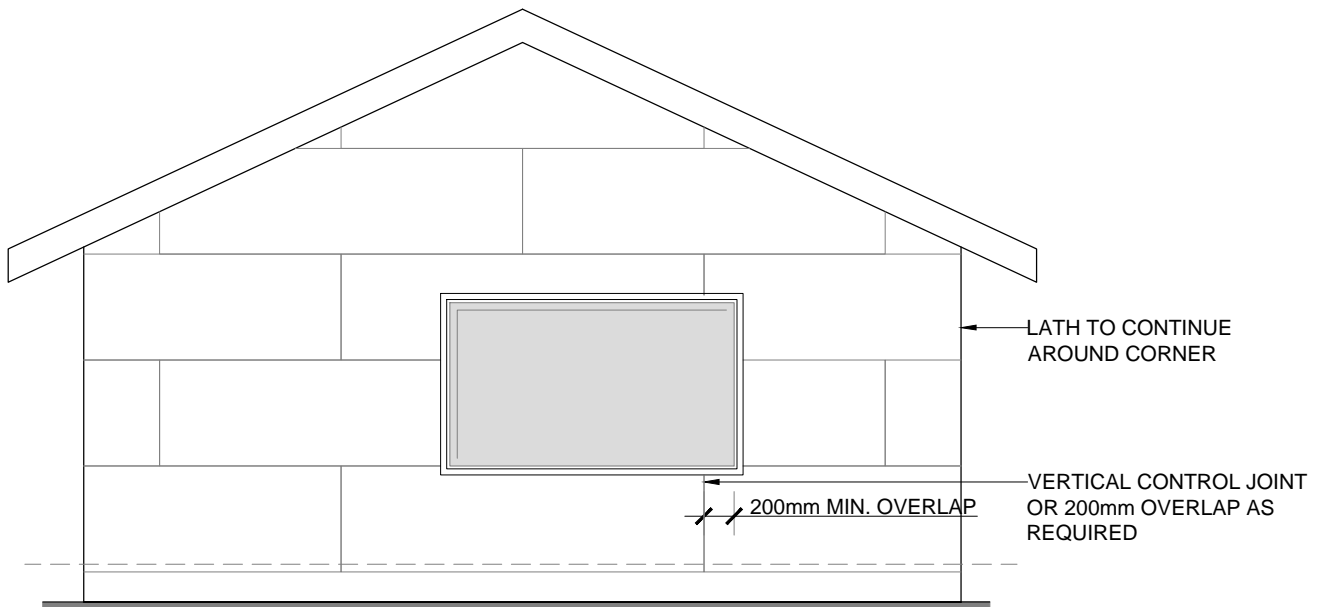

HORIZONTAL CONTROL JOINTS AT INTER-STOREY JUNCTIONS
OR AT 7000mm MAX. ON CONTINUOUS STUDS

VERTICAL CONTROL JOINTS - 6000mm MAX.CTRS **OR AT**
 DISSIMILAR MATERIAL

SCALE 1:50

STOSTUCCO SYSTEM	STOSTUCCO CONSTRUCTION SYSTEM	SS 008
	SHEET LAYOUT LAYOUT	2014

The information contained in this detail is based on our experience and testing and represents the latest information available at the date of issue. This detail is intended for use by the design professional and users of Sto products to assist in developing specific project details to be used in conjunction with a Sto Specification. We reserve the right to alter or update information at any time without prior notice & it is the responsibility of the specifier and/or the project manager to insure that they have the current Sto details and specifications.