

FRAMING STUDS 400mm CENTERS

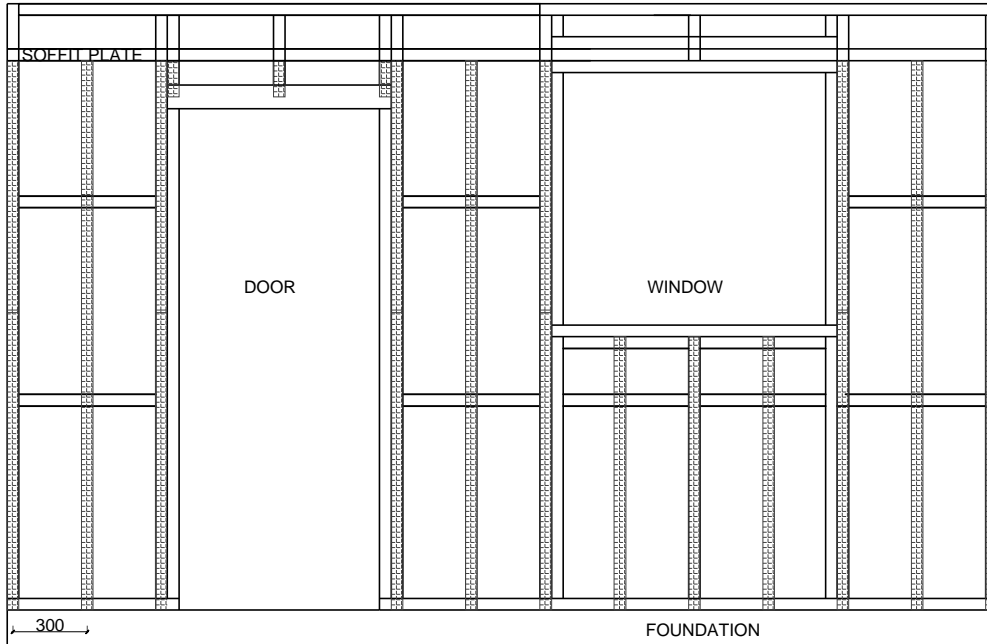

FRAMING STUDS 600mm CENTERS - WITH BATTENS @ 300mm CTRS

NOTE: EXTRA CAVITY BATTEN REQUIRED BETWEEN STUDS FOR FLEXIBLE UNDERLAY CONSTRUCTION on 600 FRAMING

N.T.S

STO POREN SYSTEM	STO POREN PANEL CLADDING SYSTEM	PP 103
	CAVITY BATTEN LAYOUT (400 & 600ctrs) ELEVATION	2014

The information contained in this detail is based on our experience and testing and represents the latest information available at the date of issue. This detail is intended for use by the design professional and users of Sto products to assist in developing specific project details to be used in conjunction with a Sto Specification. We reserve the right to alter or update information at any time without prior notice & it is the responsibility of the specifier and/or the project manager to insure that they have the current Sto details and specifications.