

STOARMAT REMEDIAL PLASTER SYSTEM FOR CRACKED AND LEAKING SUBSTRATES

STOARMAT REMEDIAL PLASTER SYSTEM

INCORPORATING:

1. STO CRACK FILLER FINE
EUROPEAN ELASTIC FILLING MATERIAL FOR CLOSING 1-10mm CRACKS.
2. STOLASTIC FILL
EUROPEAN MANUFACTURED COLD ELASTOMERIC PASTE FOR BRIDGING AND TAPING CRACKS.
3. STOLASTIC MESH
SPECIALLY ENGINEERED REINFORCEMENT MESH TO PREVENT CRACK FORMATION WITH HIGH TEAR RESISTANCE TO REINFORCE STOLASTIC FILL.
4. LEVELLITE BASE PLASTER 20kg BAG
MINERAL LITEWEIGHT BASE PLASTER FOR LEVELLING AND STRAIGHTENING WALLS, CAN BE MACHINE APPLIED.
5. STOARMAT PLASTER 23kg PAIL
EUROPEAN FIBRE REINFORCED NON-CEMENT BASED CRACK RESISTANT PLASTER USED WITH EUROPEAN MESH AS A REINFORCEMENT PLASTER.
6. STOLIT K or MP COLOURED RENDER 25kg PAIL
EUROPEAN FIBRE REINFORCED NON-CEMENT BASED COLOURED FINISHING RENDER AVAILABLE IN 1.0/1.5/2.0/3.0mm SIZED TEXTURE AND MP or MP NATURAL SPONGE FINISHED RENDER.
7. STOCOLOR MAXICRYL FACADE PAINT 15lt PAIL
STOLASTIC COLOR FACADE PAINT 15lt PAIL
STOLOTUSAN COLOR G 15lt PAIL

REMEDIAL PLASTER SYSTEM	INTRODUCTION	SAR-001
		JULY 2010

The information contained in this detail is based on our experience and testing and represents the latest information available at the date of issue. This detail is intended for use by the design professional and users of Sto products to assist in developing specific project details to be used in conjunction with a Sto Specification. We reserve the right to alter or update information at any time without prior notice & it is the responsibility of the specifier and/or the project manager to insure that they have the current Sto details and specifications.

STO DRAWING REGISTER

Drawing Description

Drawing No.

StoArmat Remedial Plaster Introduction
 StoArmat Remedial Plaster Index
 StoArmat Remedial Plaster System over Existing Plastered Polystyrene
 StoArmat Remedial Plaster System over Concrete Block Construction
 StoArmat Remedial Plaster System over Existing Plastered Fibre Cement Sheet
 StoArmat Remedial Plaster System over Existing Plastered Stucco
 Existing System Check

SAR-001
 SAR-002
 SAR-100
 SAR-101
 SAR-102
 SAR-103
 SAR-104

STOARMAT REMEDIAL PLASTER SYSTEM FOR CRACKED AND LEAKING SUBSTRATES WITH 10 YEARS SYSTEM WARRANTY

THESE DETAILS HAVE BEEN ISSUED AS A GUIDELINE ONLY TO INCORPORATE STANDARD BUILDING PRACTICES.
 ALWAYS REFER TO MANUFACTURERS CURRENT DETAILS AND SPECIFICATIONS.
 THE SEQUENCE OF WORK COVERS VARIOUS BUILDING COMPONENTS, EACH TRADE IS RESPONSIBLE TO ENSURE THEIR ELEMENTS ARE FULLY INSTALLED INCLUDING ALL WATERPROOFING/SEALANT/ FLASHINGS AS IS APPLICABLE.

REMEDIAL PLASTER SYSTEM	STOARMAT REMEDIAL PLASTER SYSTEM INDEX	SAR-002
		JULY 2010

The information contained in this detail is based on our experience and testing and represents the latest information available at the date of issue. This detail is intended for use by the design professional and users of Sto products to assist in developing specific project details to be used in conjunction with a Sto Specification. We reserve the right to alter or update information at any time without prior notice & it is the responsibility of the specifier and/or the project manager to insure that they have the current Sto details and specifications.

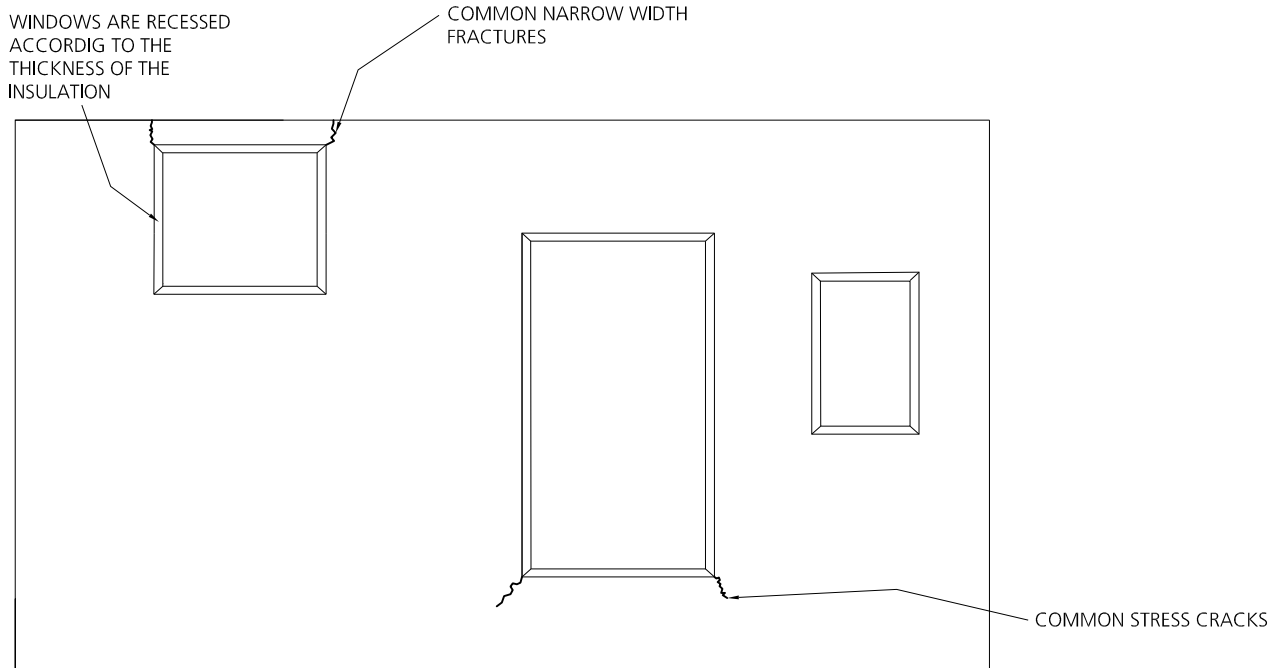

1. EXISTING POLYSTYRENE CLADDING CHECK:
 CHECK FOR CRACKS AT JOINERY REVELS, CORNERS AND GARAGE DOOR OPENINGS
 CHECK NARROW WIDTH FOR FRACTURES
 CHECK EXISTING JOINERY
 CHECK FOR IMPACT DAMAGE
 CONTROL JOINTS ARE REQUIRED VERTICALLY EVERY 20 LINEAR METRES AND HORIZONTALLY WITH THIRD STOREY OR EVERY 6 METRES EXCLUDING GABLES.
2. EXISTING ALUMINIUM JOINERY CHECK:
 CHECK JOINERY MITRES FOR LEAKS AND RESEAL AS REQUIRED, TO BE CARRIED OUT BY JOINERY INSTALLER
 CHECK JOINERY HAS uPVC JAMB AND SILL FLASHINGS - HEAD FLASHINGS
 CHECK JAMB AND SILL/CLADDING HAS A PERIMETER SEALANT
 CUT OUT POLY AND INSTALL FLASHINGS / MS SEALANT AS REQUIRED
 REINFORCE ANY CRACKS WITH STOLASTIC FILL RF MESH
3. APPLICATION - SS106R STOARMAT REMEDIAL PLASTER SYSTEM:
 a. STOLASTIC FILL/STO RF MESH CRACK ADDRESSMENT
 b. IF REQUIRED LEVELLITE BASECOAT PLASTER TO LEVEL TEXTURE
 c. STOARMAT MESHED REINFORCEMENT PLASTER
 d. STOLIT K COLOURED FINISHING RENDER
 e. STOCOLOR MAXICRYL OR STOLASTIC COLOR FACADE PAINT

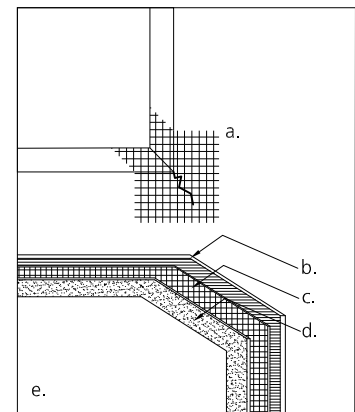

REMEDIAL PLASTER SYSTEM	SS106R - STOARMAT REMEDIAL PLASTER SYSTEM OVER EXISTING PLASTERED POLYSTYRENE	SAR-100
		JULY 2010

The information contained in this detail is based on our experience and testing and represents the latest information available at the date of issue. This detail is intended for use by the design professional and users of Sto products to assist in developing specific project details to be used in conjunction with a Sto Specification. We reserve the right to alter or update information at any time without prior notice & it is the responsibility of the specifier and/or the project manager to insure that they have the current Sto details and specifications.

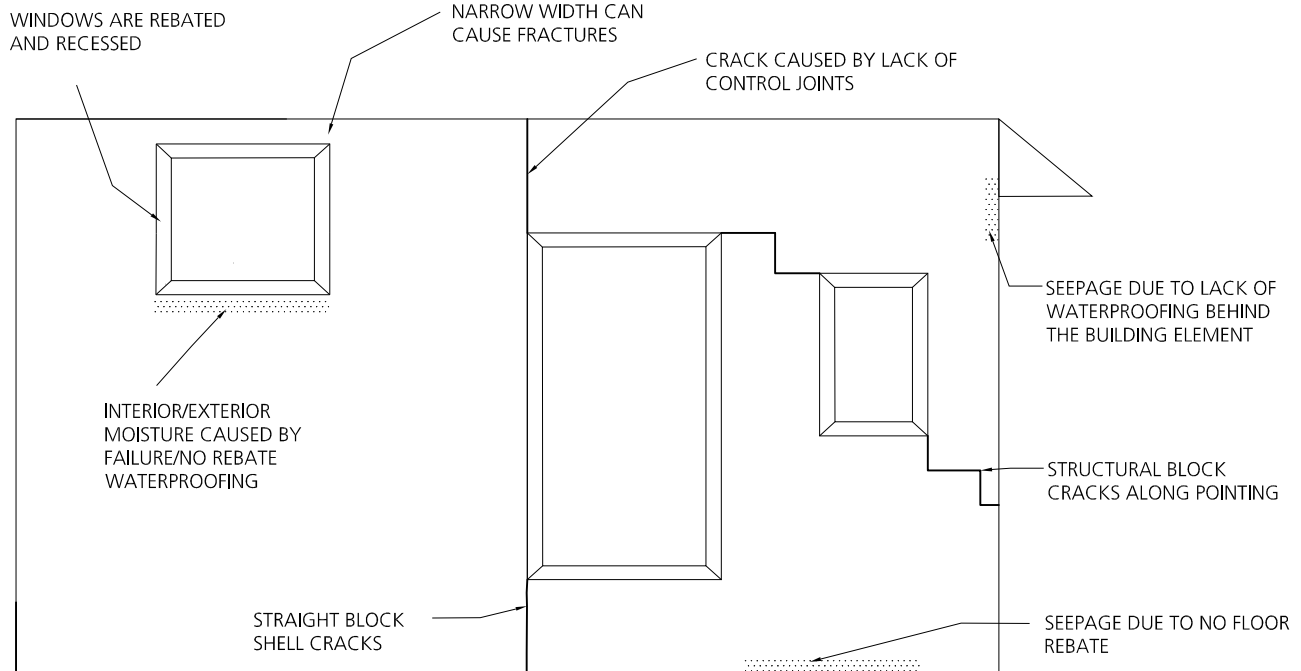

1. EXISTING EXTERIOR CHECK:
CHECK JOINERY REBATES FOR CRACKS ESPECIALLY SILL BLOCKS
CHECK GROUND FLOOR / BLOCK JOINTING FOR FRACTURES
CHECK AREAS ADJACENT OR OVER BLOCKS ARE WATERTIGHT - SOFFITS, PORCHES, ETC.
CONTROL JOINTS ARE REQUIRED VERTICALLY EVERY 6 LINEAR METRES OR AS PER THE ENGINEER'S OR MANUFACTURER'S DRAWINGS
2. EXISTING ALUMINIUM JOINERY CHECK:
CHECK JOINERY MITRES FOR LEAKS AND RESEAL AS REQUIRED, TO BE CARRIED OUT BY JOINERY INSTALLER
CHECK CONCRETE BLOCK REBATES HAVE BEEN USED
CHECK CONCRETE BLOCK REBATES HAVE BEEN WATERPROOFED
CHECK WINDOW PERIMETER HAS A SEALANT BEAD - SILLS CAN HAVE 5 MM GAP
NOTE: IF JOINERY HAS BEEN INSTALLED ON TIMBER REBATES CHECK WATERPROOFING DETAILS
3. APPLICATION - SS202R STOARMAT REMEDIAL PLASTER SYSTEM:
a. STOLASTIC FILL/STO RF MESH CRACK ADDRESSMENT
b. IF REQUIRED LEVELLITE BASECOAT PLASTER TO LEVEL TEXTURE
c. STOARMAT MESHED REINFORCEMENT PLASTER
d. STOLIT K COLOURED FINISHING RENDER
e. STOCOLOR MAXICRYL OR STOLASTIC COLOR FACADE PAINT (STO FLEXYL WATERPROOFING TO JOINERY REBATES IF REQUIRED)

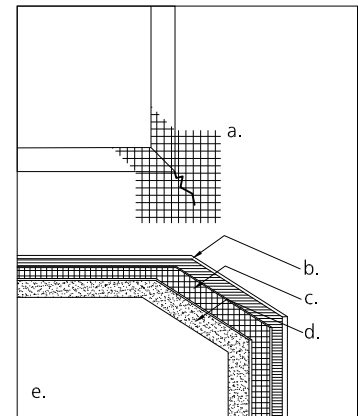

REMEDIAL PLASTER SYSTEM	SS202R - STOARMAT REMEDIAL PLASTER SYSTEM OVER CONCRETE BLOCK CONSTRUCTION	SAR-101
		JULY 2010

The information contained in this detail is based on our experience and testing and represents the latest information available at the date of issue. This detail is intended for use by the design professional and users of Sto products to assist in developing specific project details to be used in conjunction with a Sto Specification. We reserve the right to alter or update information at any time without prior notice & it is the responsibility of the specifier and/or the project manager to insure that they have the current Sto details and specifications.

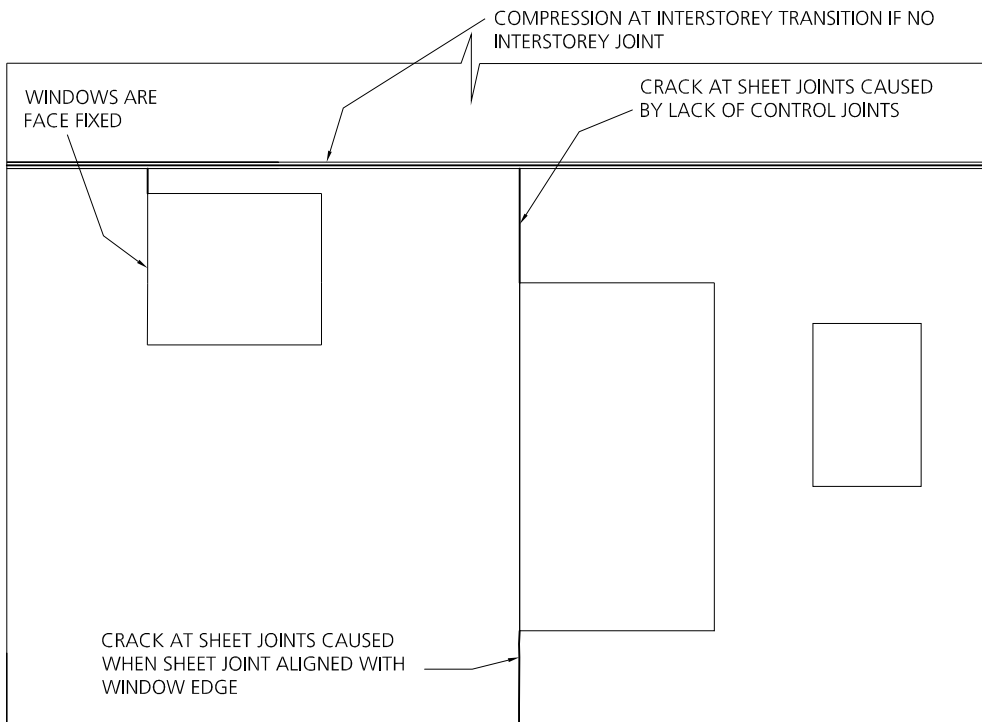

1. EXISTING EXTERIOR CHECK:
 CHECK AROUND JOINERY FOR CRACKS ESPECIALLY WHERE SHEET HAS BEEN JOINED ON JOINERY JAMB LINE
 CHECK FOR COMPRESSED OR CRACKED INTERSTOREY JOINTS
 CHECK FOR SHEET JOINT FAILURE, SHEET CRACKING OR LOSE FIXINGS
 CHECK GROUND CLEARANCES, FIXTURES AND DAMAGE
 CONTROL JOINTS ARE REQUIRED VERTICALLY EVERY 5.4 LINEAR METRES AND HORIZONTALLY AT EVERY INTERSTOREY OR 5.4 METRES EXCLUDING GABLES
2. EXISTING ALUMINIUM JOINERY CHECK:
 CHECK JOINERY MITRES FOR LEAKS AND RESEAL AS REQUIRED, TO BE CARRIED OUT BY JOINERY INSTALLER
 CHECK HEAD FLASHING IS OVER SEATING WINDOW JOINERY
 CHECK JAMBS AND SILL HAVE BEEN SEALED WITH SEALANT
3. APPLICATION - SS404R STOARMAT REMEDIAL PLASTER SYSTEM:
 - a. STOARMAT /JOINTING TAPE FOR FAILED JOINTS
 - b. STOLASTIC FILL/STOLF MESH CRACK ADDRESSMENT
 - c. IF REQUIRED LEVELLITE BASECOAT PLASTER TO LEVEL TEXTURE
 - d. STOARMAT MESHED REINFORCEMENT PLASTER
 - e. STOLIT K COLOURED FINISHING RENDER
 - f. STOCOLOR MAXICRYL OR STOLASTIC COLOR FACADE PAINT

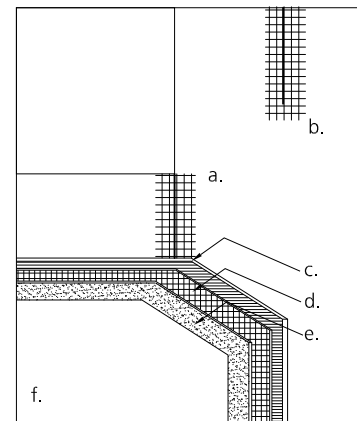

REMEDIAL PLASTER SYSTEM	SS404R - STOARMAT REMEDIAL PLASTER SYSTEM	SAR-102
	OVER EXISTING PLASTERED FIBRE CEMENT SHEET	JULY 2010

The information contained in this detail is based on our experience and testing and represents the latest information available at the date of issue. This detail is intended for use by the design professional and users of Sto products to assist in developing specific project details to be used in conjunction with a Sto Specification. We reserve the right to alter or update information at any time without prior notice & it is the responsibility of the specifier and/or the project manager to insure that they have the current Sto details and specifications.

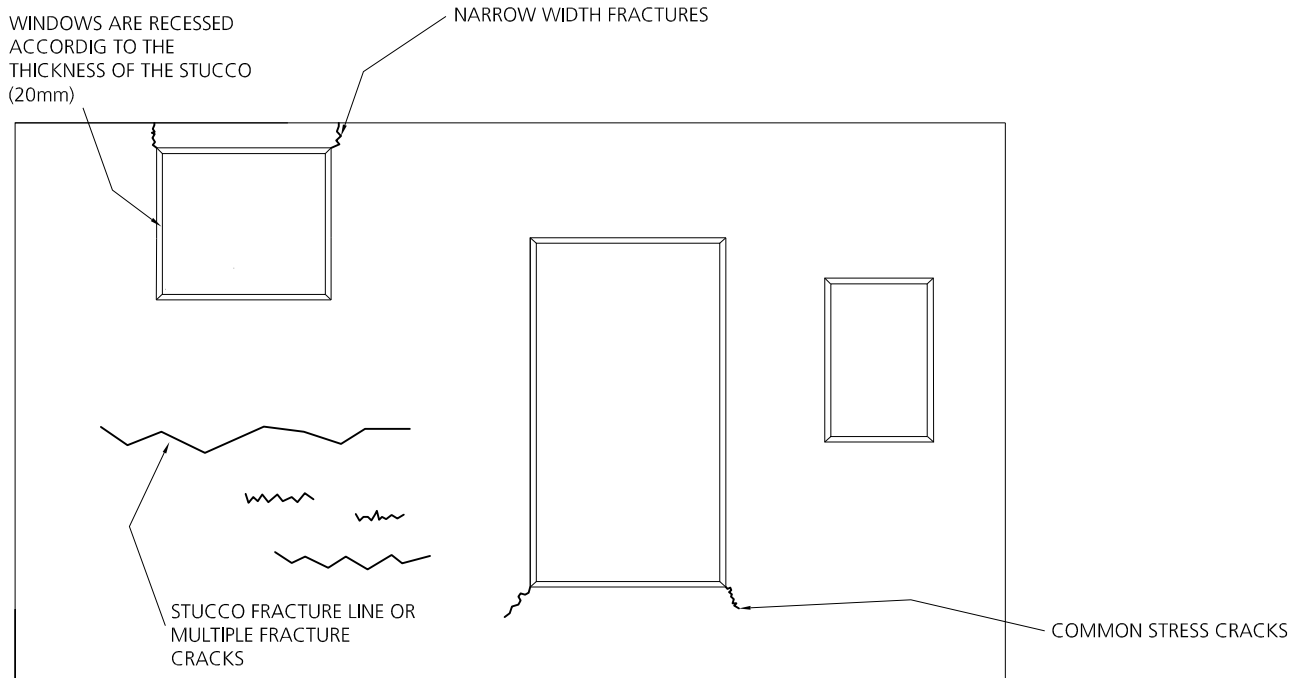

1. EXISTING EXTERIOR CHECK:
CHECK FOR CRACKS AT JOINERY REVELS, CORNERS AND GARAGE DOOR OPENINGS
CHECK NARROW WIDTH FOR FRACTURES
CHECK EXISTING JOINERY
CHECK FOR PLASTERED LATH DAMAGE
CHECK CONTROL JOINTS SHOULD BE IN ACCORDANCE WITH NZS
2. EXISTING ALUMINIUM JOINERY CHECK:
CHECK JOINERY MITRES FOR LEAKS AND RESEAL AS REQUIRED, TO BE CARRIED OUT BY JOINERY INSTALLER
CHECK JOINERY HAS JAMB SILL AND HEAD FLASHINGS
CHECK JOINERY HAVE BEEN SEALED WITH SEALANT CORRECTLY
REINFORCE ANY CRACKS WITH STOLASTIC FILL RF MESH
3. APPLICATION - SS303R STOARMAT REMEDIAL PLASTER SYSTEM:
REMOVE ANY AREAS WHERE LATH/PLASTER HAVE FAILED AND REPLACE
 - a. STOARMAT MESHED OVER SOUND CRACKED LATH AREAS
 - b. STOLASTIC FILL/STO RF MESH CRACK ADDRESSMENT
 - c. IF REQUIRED LEVELLITE BASECOAT PLASTER TO LEVEL TEXTURE
 - d. STOARMAT MESHED REINFORCEMENT PLASTER
 - e. STOLIT K COLOURED FINISHING RENDER
 - f. STOCOLOR MAXICRYL OR STOLASTIC COLOR FACADE PAINT

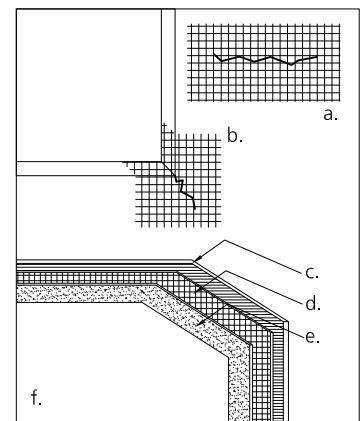

REMEDIAL PLASTER SYSTEM	SS303R - STOARMAT REMEDIAL PLASTER SYSTEM OVER EXISTING PLASTERED STUCCO	SAR-103
		JULY 2010

The information contained in this detail is based on our experience and testing and represents the latest information available at the date of issue. This detail is intended for use by the design professional and users of Sto products to assist in developing specific project details to be used in conjunction with a Sto Specification. We reserve the right to alter or update information at any time without prior notice & it is the responsibility of the specifier and/or the project manager to insure that they have the current Sto details and specifications.

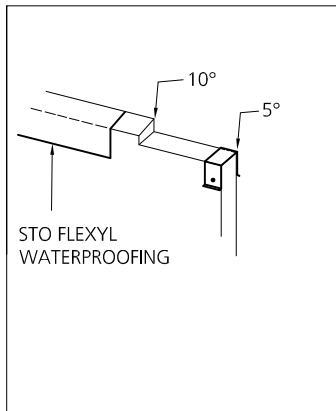

EXISTING PARAPETS, BALUSTRADES AND LEDGES:

CHECK ALL TOPS FOR ADEQUATE FALL - METAL AT 5° AND PLASTERED AT 10°

PLASTERED TOPS ARE TO HAVE STO FLEXYL MESHED WATERPROOFING INSTALLED IN ACCORDANCE TO THE SPECIFICATION

ENSURE ANY TOP FIXINGS OR FIXTURES ARE REMOVED AND REPOSITIONED OR USE AN APPROVED WATERPROOF DETAIL

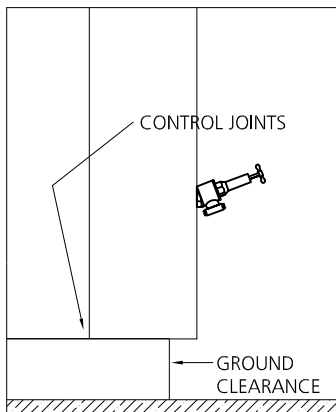

FITTINGS / GROUND CLEARANCE:

ENSURE ALL TAPS, GAS FITTINGS, LIGHTS RAINWATER HEADS, ETC. ARE SECURE AND WATERTIGHT

CHECK GROUND CLEARANCE MEETS NZBC

CHECK CONTROL JOINTS ARE INSTALLED IN ACCORDANCE WITH SUBSTRATE MANUFACTURERS REQUIREMENTS

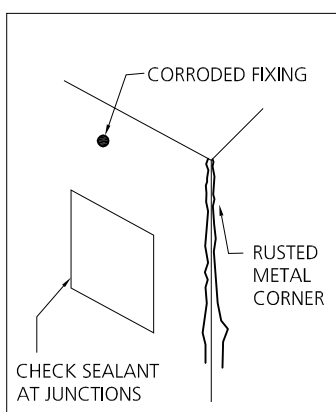

CLADDING CONDITION:

ALL TRANSITIONS, JUNCTIONS, SEALANT JOINTS ARE TO BE CHECKED

REMOVE ANY CORRODED FLASHINGS, FIXINGS OR METAL CORNERS

ENSURE INTERSECTING ROOFS HAVE DIVERTER FLASHINGS INSTALLED

CONTROL JOINTS AND INTERSTOREY JOINTS SHOULD BE INSTALLED AS REQUIRED BY THE SUBSTRATE MANUFACTURER

**REMEDIAL
PLASTER SYSTEM**

EXISTING SYSTEM CHECK

SAR-104

JULY 2010

The information contained in this detail is based on our experience and testing and represents the latest information available at the date of issue. This detail is intended for use by the design professional and users of Sto products to assist in developing specific project details to be used in conjunction with a Sto Specification. We reserve the right to alter or update information at any time without prior notice & it is the responsibility of the specifier and/or the project manager to insure that they have the current Sto details and specifications.