

SCALE 1:2

STO BRICK SYSTEM	STO BRICK SYSTEM	PB 870
	TIMBER JOINERY HEAD DETAIL	2019

The information contained on this page is based on our experience and research at the date of issue. The detail is for use by Registered Architects, Licensed Designers or Chartered Engineers to assist in developing project details using Sto Systems. Stoanz Ltd reserve the right to alter or update information at any time without prior notice and it is the responsibility of the designer, project manager or Sto contractor to insure they have and use the current Sto details and specifications on site.

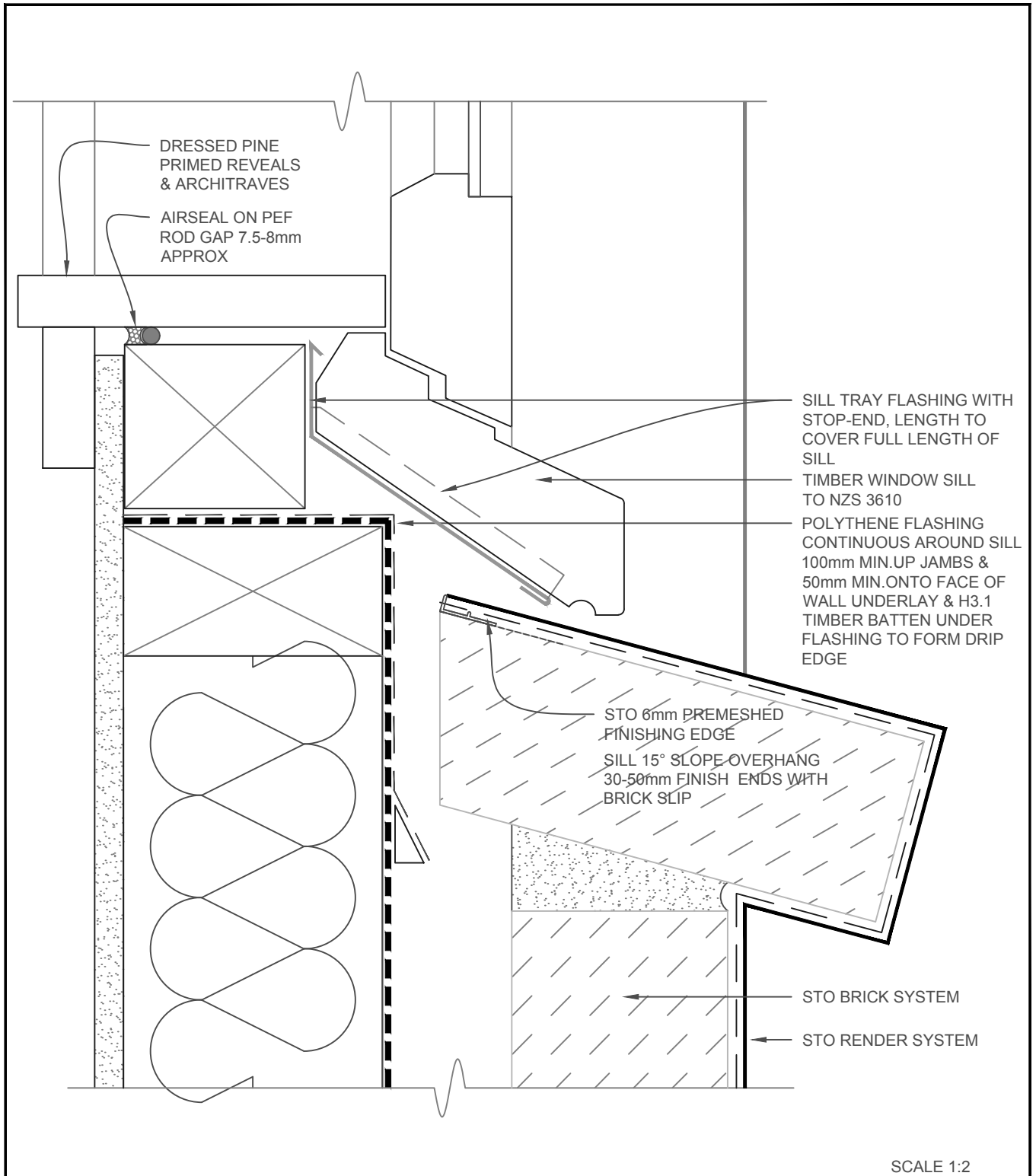

STO BRICK SYSTEM	STO BRICK SYSTEM	PB 871
	TIMBER JOINERY SILL DETAIL	2019

The information contained on this page is based on our experience and research at the date of issue. The detail is for use by Registered Architects, Licensed Designers or Chartered Engineers to assist in developing project details using Sto Systems. Stoanz Ltd reserve the right to alter or update information at any time without prior notice and it is the responsibility of the designer, project manager or Sto contractor to insure they have and use the current Sto details and specifications on site.

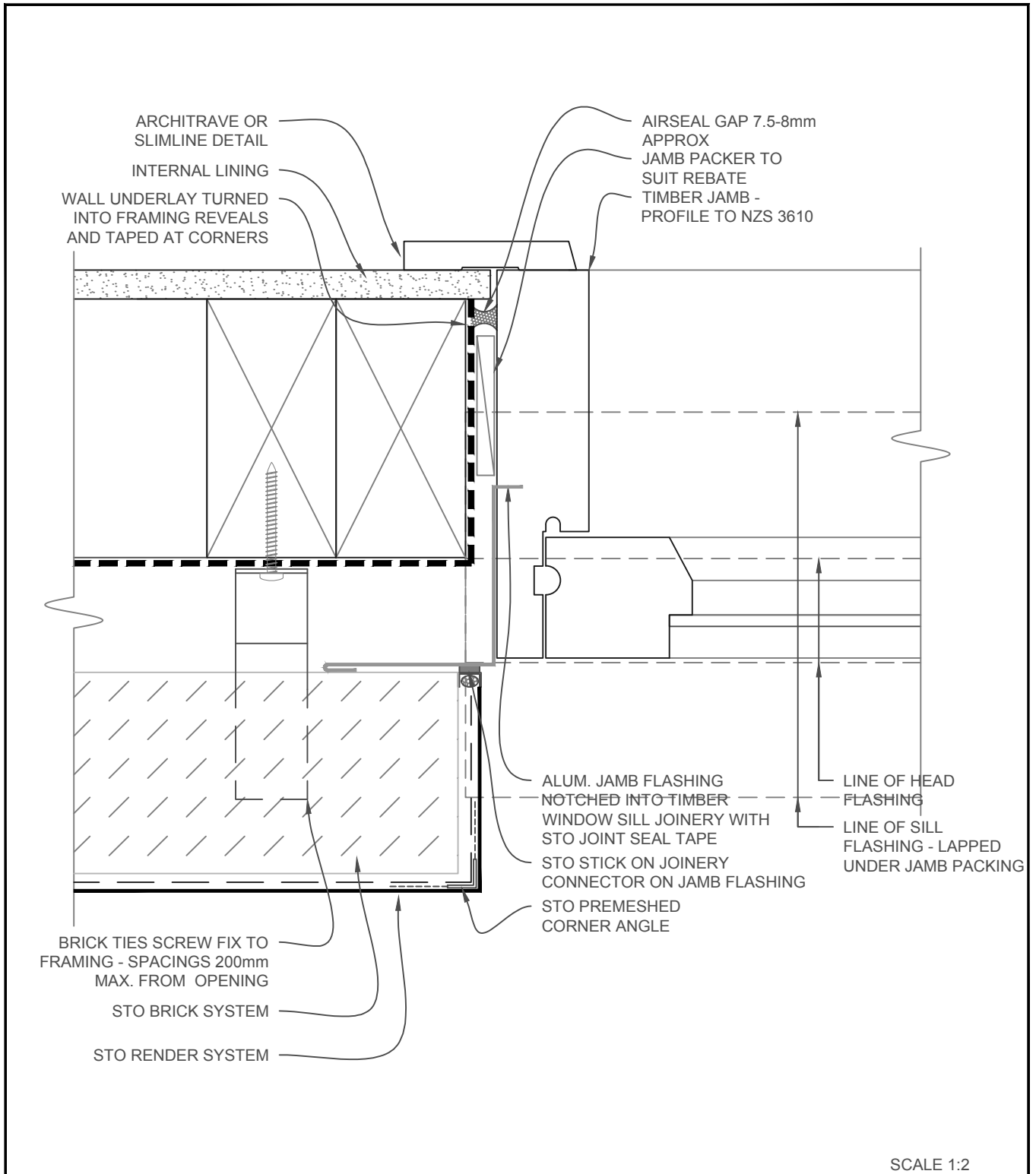

SCALE 1:2

STO BRICK SYSTEM	STO BRICK SYSTEM	PB 872
	TIMBER WINDOW JOINERY - JAMB DETAIL	2019

The information contained on this page is based on our experience and research at the date of issue. The detail is for use by Registered Architects, Licensed Designers or Chartered Engineers to assist in developing project details using Sto Systems. Stoanz Ltd reserve the right to alter or update information at any time without prior notice and it is the responsibility of the designer, project manager or Sto contractor to insure they have and use the current Sto details and specifications on site.

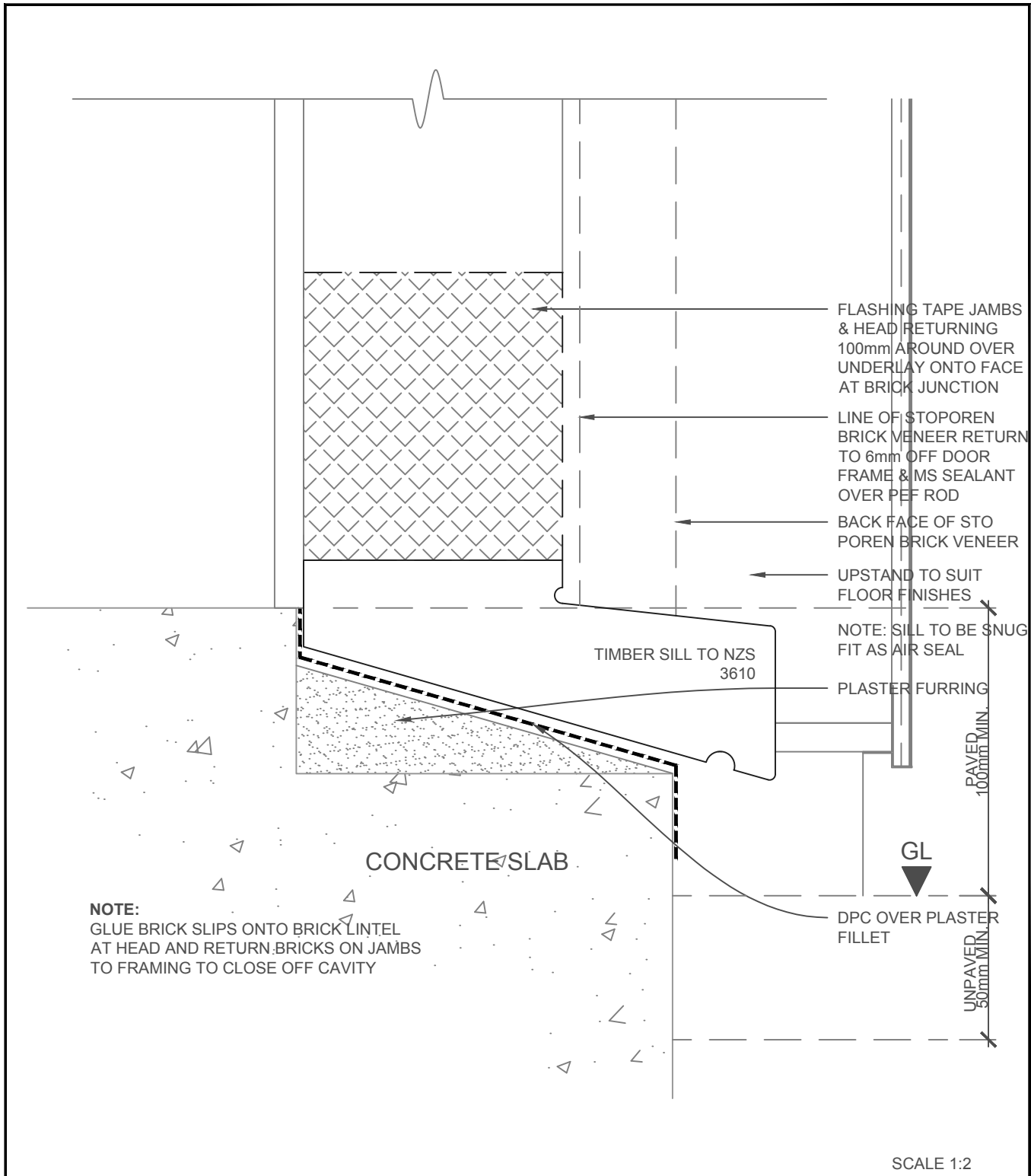

STO BRICK SYSTEM	STO BRICK SYSTEM	PB 873
	TIMBER DOOR JOINERY - CONC.FLOOR THRESHOLD DETAIL	2019

The information contained on this page is based on our experience and research at the date of issue. The detail is for use by Registered Architects, Licensed Designers or Chartered Engineers to assist in developing project details using Sto Systems. Stoanz Ltd reserve the right to alter or update information at any time without prior notice and it is the responsibility of the designer, project manager or Sto contractor to insure they have and use the current Sto details and specifications on site.